

Bar & Pipe Guide YM99CW

ELDON
SPECIALTIES, INC.

PO Box 567 * 821 E. Parker St. Ext.
Graham, NC 27253 * USA
(336) 229-6622 * Fax (336) 229-7180
sales@eldonspecialties.com
www.eldonspecialties.com

We offer various **Bar Guides** at your required length.
Matt finish (HF2, up to 380mm) and **Slant Cut** are available.

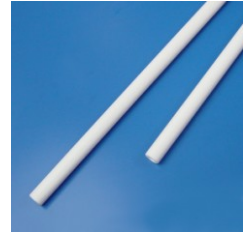
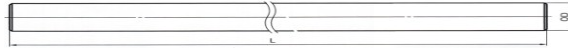

Straight cut To complete Drawing No., please fill the length in 3figures at ***.

| DIA (mm) | Drawing NO. | Maximum Length (mm) | Drawing NO. | Maximum Length (mm) |
|----------|-------------|---------------------|---------------|---------------------|
| 3 | B208003L*** | 500 | B208003L***-4 | 380 |
| 4 | B208004L*** | | B208004L***-4 | |
| 5 | B208005L*** | | B208005L***-4 | |
| 6 | B208006L*** | | B208006L***-4 | |
| 8 | B208008L*** | | B208008L***-4 | |
| 10 | B208010L*** | | B208010L***-4 | |
| 12 | B208012L*** | 300 | B208012L***-4 | |
| 14 | B208014L*** | 500 | B208014L***-4 | |
| 16 | B208016L*** | | B208016L***-4 | |

e.g.) B208010L180 - DIA10mm, Length 180mm, YM99CW

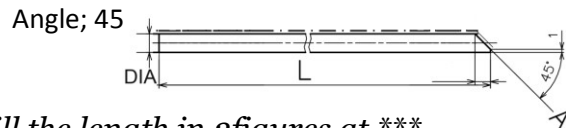
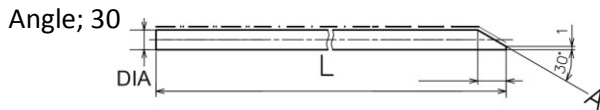

Slant cut To complete Drawing No., please fill the length in 3figures at ***.

| DIA (mm) | ANGLE (DEGREE) | Drawing NO. | Maximum Length (mm) | ANGLE (DEGREE) | Drawing NO. | Maximum Length (mm) |
|----------|----------------|--------------|---------------------|----------------|----------------|---------------------|
| 3 | 30 | L208003L***A | 500 | 30 | L208003L***A-4 | 380 |
| | 45 | L208003L***B | | 45 | L208003L***B-4 | |
| 4 | 30 | L208004L***A | | 30 | L208004L***A-4 | |
| | 45 | L208004L***B | | 45 | L208004L***B-4 | |
| 5 | 30 | L208005L***A | | 30 | L208005L***A-4 | |
| | 45 | L208005L***B | | 45 | L208005L***B-4 | |
| 6 | 30 | L208006L***A | 30 | L208006L***A-4 | | |
| | 45 | L208006L***B | 45 | L208006L***B-4 | | |

e.g.) L208004L045A-4 - DIA4mm, Length 45mm, Slant cut 30degree, YM99CW-HF2

Slant cut with other diameters - such as DIA8, 10, 12, 14 and 16 - are also available.

Bar & Pipe Guide YM99CW

ELDON
SPECIALTIES, INC.

PO Box 567 * 821 E. Parker St. Ext.
Graham, NC 27253 * USA
(336) 229-6622 * Fax (336) 229-7180
sales@eldonspecialties.com
www.eldonspecialties.com

We offer various **Pipe Guides** at your required length.
Matt finish (HF2) is available up to 380mm for your application.



To complete Drawing No., Please fill the length in 3 figures at ***.

| OD (mm) | ID (mm) | Drawing NO. | Material | Maximum Length (mm) | Drawing NO. | Material | Maximum Length (mm) |
|---------|---------|-------------|----------|---------------------|---------------|------------|---------------------|
| 4 | 2 | B605004L*** | YM99CW | 500 | B605004L***-4 | YM99CW-HF2 | 380 |
| 6 | 3 | B605006L*** | YM99CW | 1,000 | B605006L***-4 | YM99CW-HF2 | |
| 8 | 4 | B605008L*** | YM99CW | | B605008L***-4 | YM99CW-HF2 | |
| 10 | 5 | B605010L*** | YM99CW | | B605010L***-4 | YM99CW-HF2 | |
| 12 | 6 | B605012L*** | YM99CW | | B605012L***-4 | YM99CW-HF2 | |
| 16 | 8 | B605016L*** | YM99CW | 500 | B605016L***-4 | YM99CW-HF2 | |

e.g.) B605006L260-4 - OD6mm, ID3mm, Length260mm, YM99CW-HF2

For other spec - Longer length and YM99C or YM85C material, Please feel free to contact us.